



VIBROturn

Improves your manufacturing processes
and increases the efficiency of your production!



Low-frequency vibration-assisted turning- VIBROturn



Vibration-assisted turning – VIBROturn



Product line – VIBROturn

Innovative tool holders

- Self-driven or driven tool
- Rigid bearing of the tool holder
- High performance

Performance:

Frequency:	$f_{\text{vib}} = 1...100 \text{ Hz}$
Stroke (adjustable):	$\hat{A} = 0...0,6 \text{ mm}$
Process forces:	$f_{c, \text{max}} = 9 \text{ kN}$

- Flexible retrofitting independent of the machine manufacturer

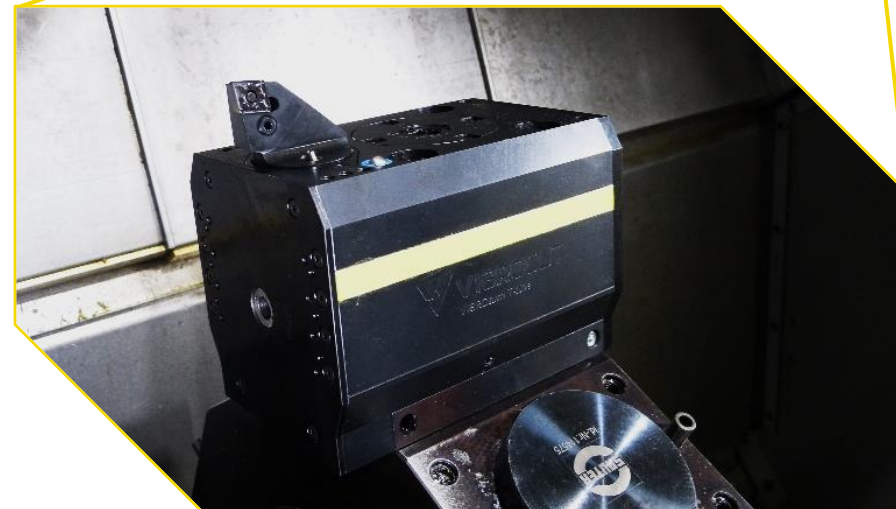
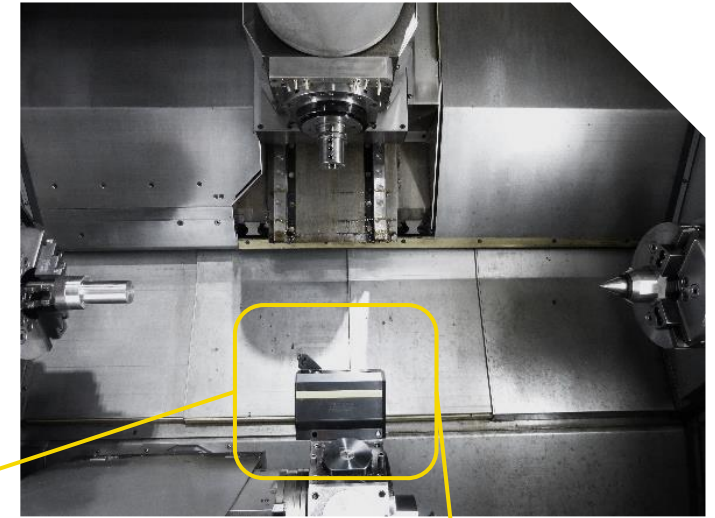

VIBROturn for driven tool stations

Vibration-assisted turning – VIBROturn



Machine equipment

- Retrofittable tool holders for turret lathes
- Drive of the vibration unit through turret or additional drive
- Various swing directions and tool arrangements possible

Product overview

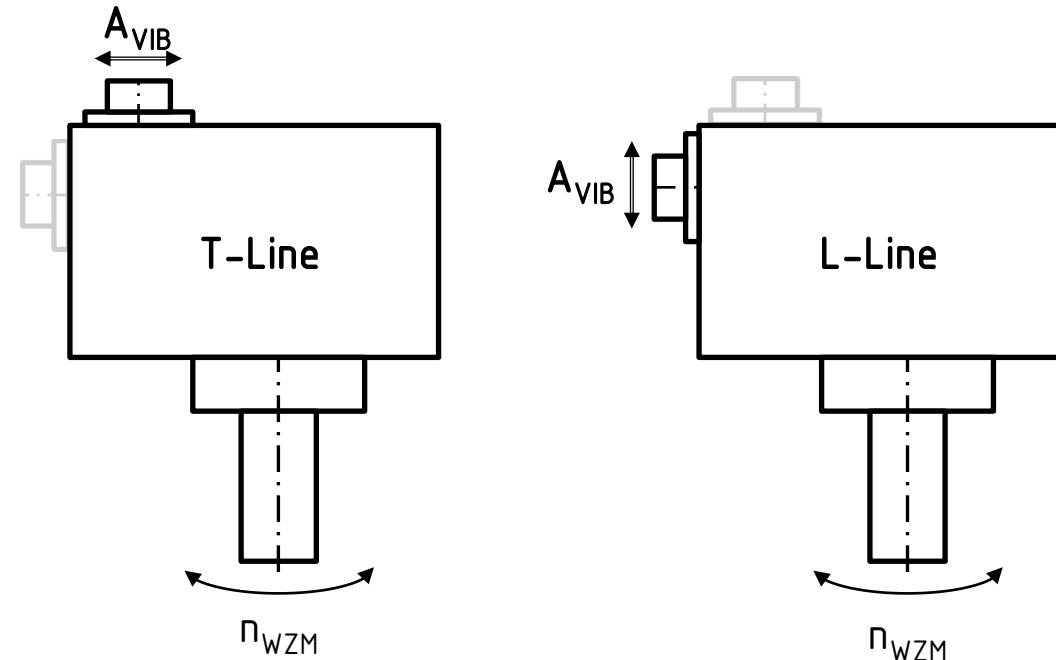

Services

- Preliminary technological studies
- Training courses
- Technological support during production start-up
- Maintenance and service

VIBROturn- T-Line



T-LINE

Orthogonal oscillation direction towards the driving axle

Dimensions		Compact	Standard	Heavy
	A	60...75*	96	110
	B	85...90	110	140
	C	90	115	145
	D	65	70	75...80
	E	70	90	119
	F	75	100	128
	G	50	64	75

Interface

Machine interface**	VDI 25 VDI 30 BMT 45	VDI 40 VDI 50 BMT 55 BMT 65	VDI 60 VDI 70 BMT 65 BMT 75
Couplings**	Double d (DIN 1809,...), Gear (DIN 5480, DIN 5482,...)		
Tool interface**	PSC 32	PSC 40	PSC 63

Specific information

Maximum frequency	100 Hz	100 Hz	60 Hz
Vibration amplitudes	0,4 mm	0,6 mm	0,6 mm
Coolant pressure (IKZ+AKZ)	20 bar	20 bar	20 bar
Process forces	5 kN	9 kN	12 kN

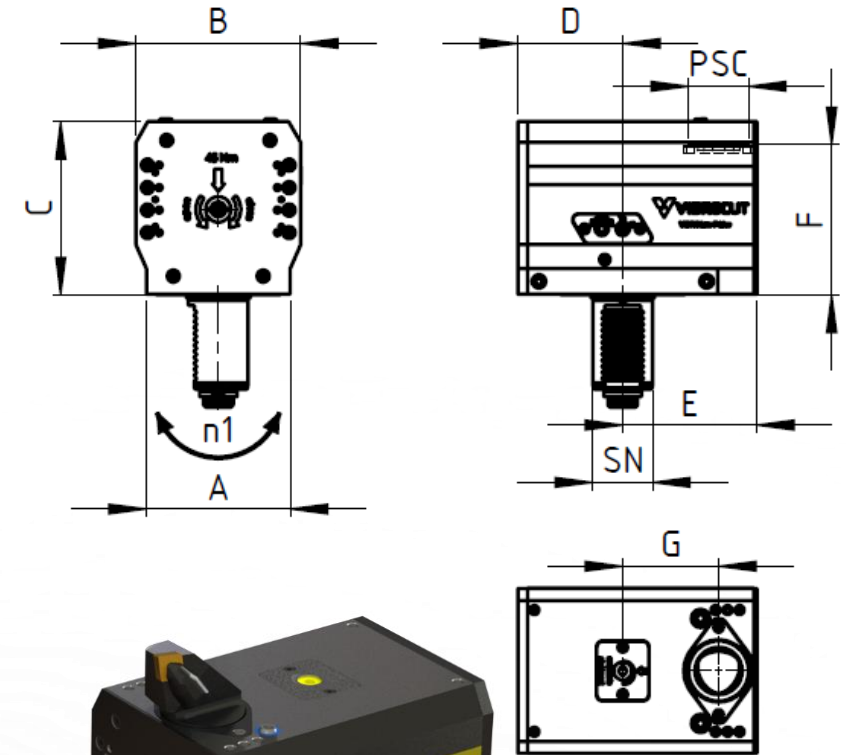

* depending on machine interface
** Special versions on request



L-LINE

Lateral oscillation direction towards the driving axle

Dimensions	Compact	Standard	Heavy
A	60-75*	96	110
B	90	110	140
C	90	120	154
D	65	70	75
E	95	95	123
F	80	81,5	106
G	69	95	110

Interfaces

Machine interface**	VDI 25 VDI 30 BMT 45	VDI 40 VDI 50 BMT 55 BMT 65	VDI 60 VDI 70 BMT 65 BMT 75
Couplings**	Double d (DIN 1809,...), Gear (DIN 5480, DIN 5482,...)		
Tool interface**	PSC 32	PSC 40	PSC 63

Specific information

Maximum frequency	100 Hz	100 Hz	60 Hz
Vibration amplitudes	0,4 mm	0,6 mm	0,6 mm
Coolant pressure (IKZ+AKZ)	20 bar	20 bar	20 bar
Process forces	5 kN	9 kN	12 kN

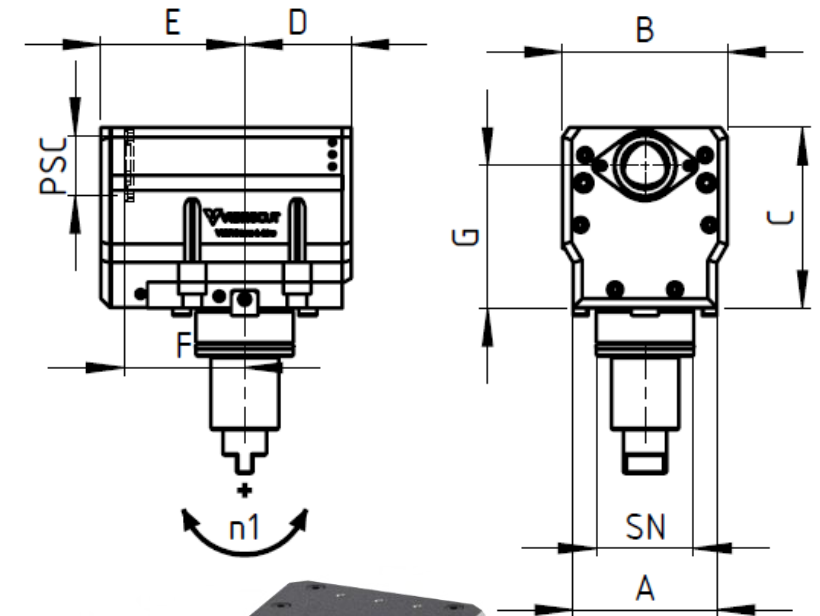

* depending on machine interface
** Special versions on request

Contact details



VIBROturn

✉ info@vibrocut.de

☎ +49 371 335656-0



VibroCut GmbH

📍 Annaberger Str. 240
09125 Chemnitz
Germany

🌐 www.vibrocut.de



*„VibroCut combines
technique and technology
for vibration-assisted
machining“*

